

STREET LIGHTING FOR TOMORROW

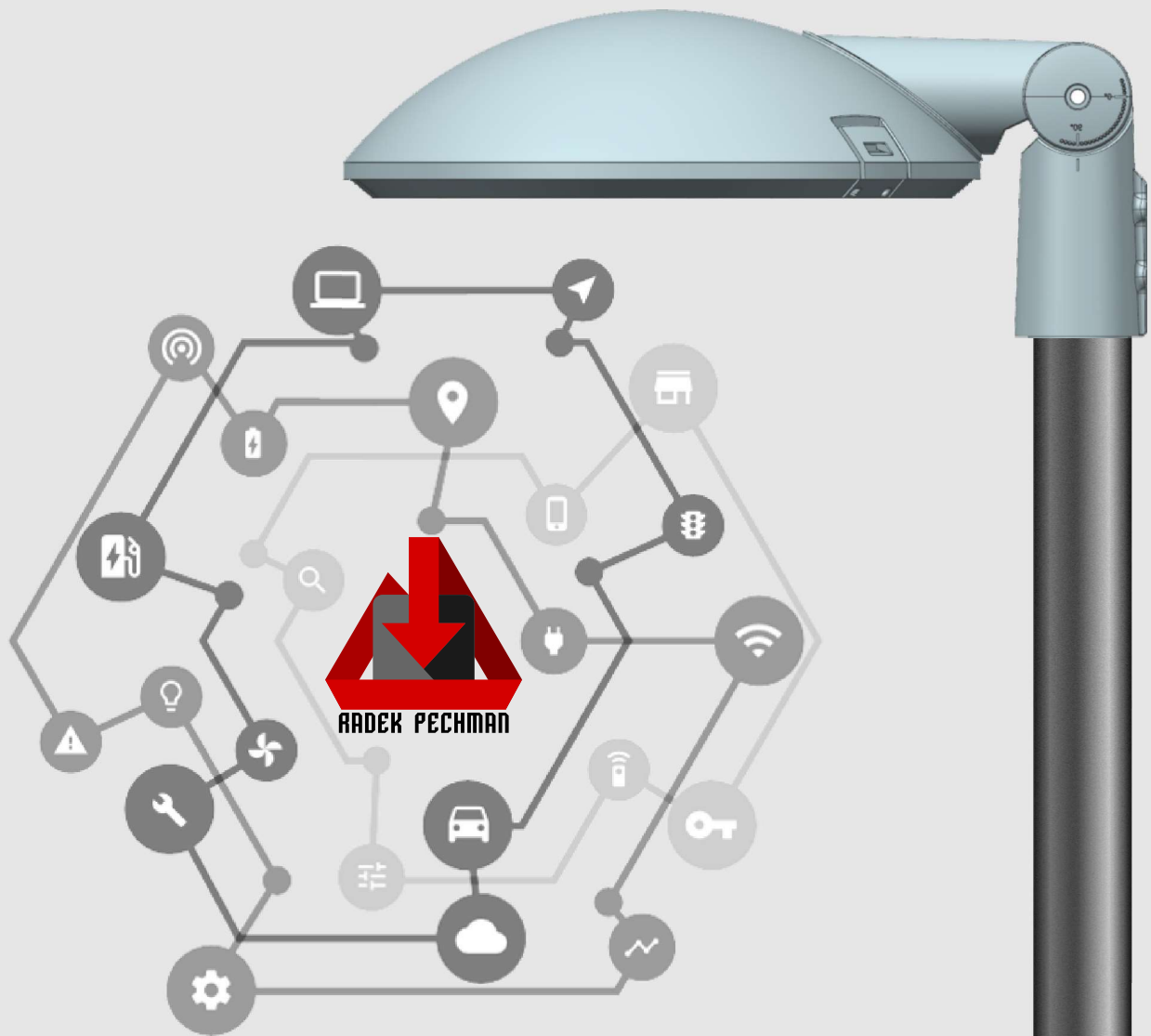

TERA S

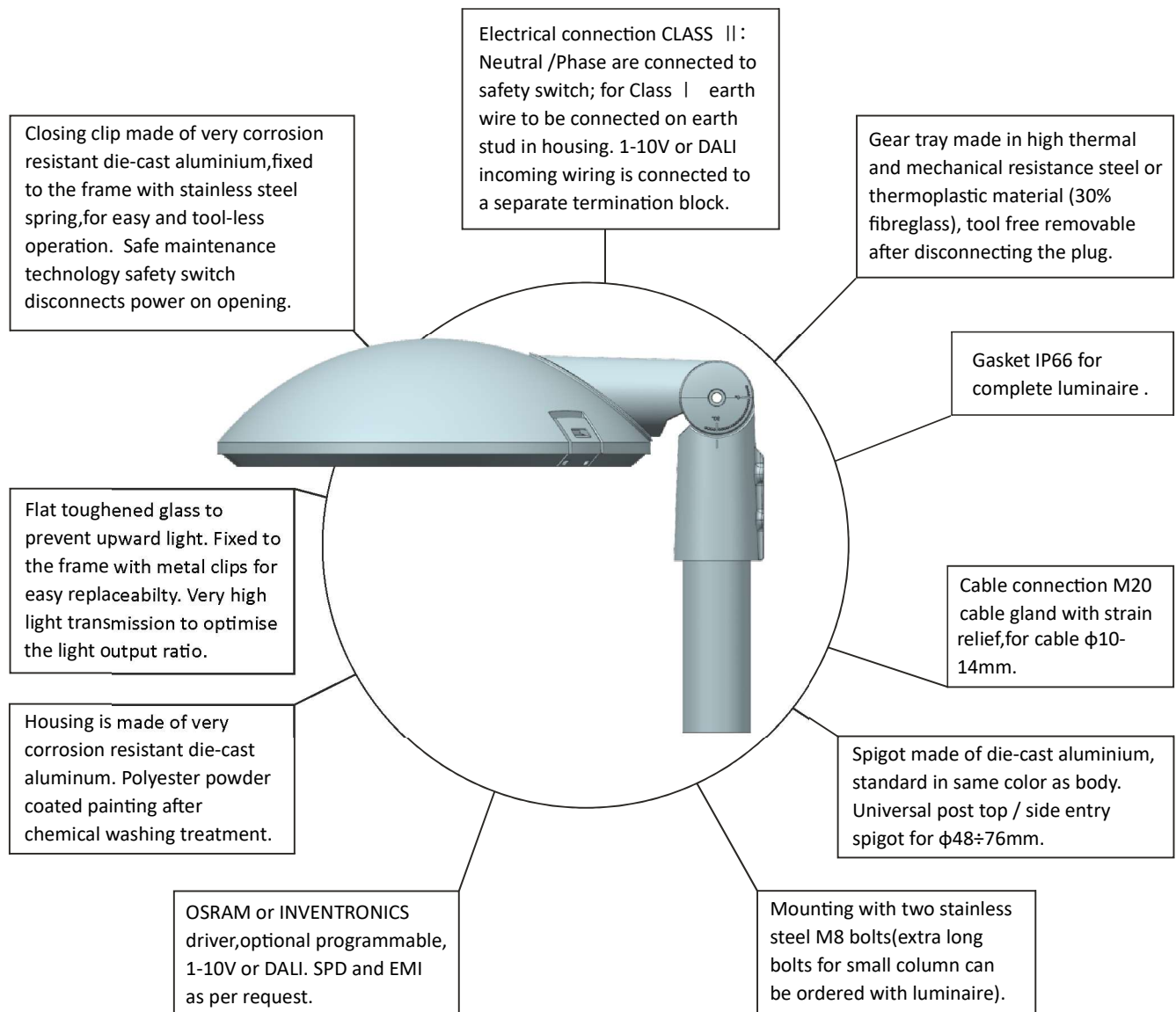



Key Advantage:

- smart and versatile design of 2-in-1 installation, post-top mounting, bracket side entry mounting
- High luminaire efficiency
- Many kinds of optics and advanced thermal management
- Tool free installation and maintenance
- Outstanding self-cleaning capability
- Dark sky friendly and no upward light, up to G6 glare rating
- Flexible and intelligent drivers for smart city
- Low wind area and drop protector



OVERVIEW

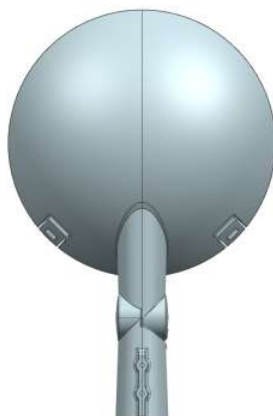
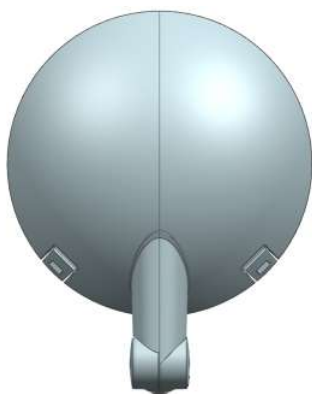

TERA S „P“



TERA S „B“



OVERVIEW

TERA S „P”

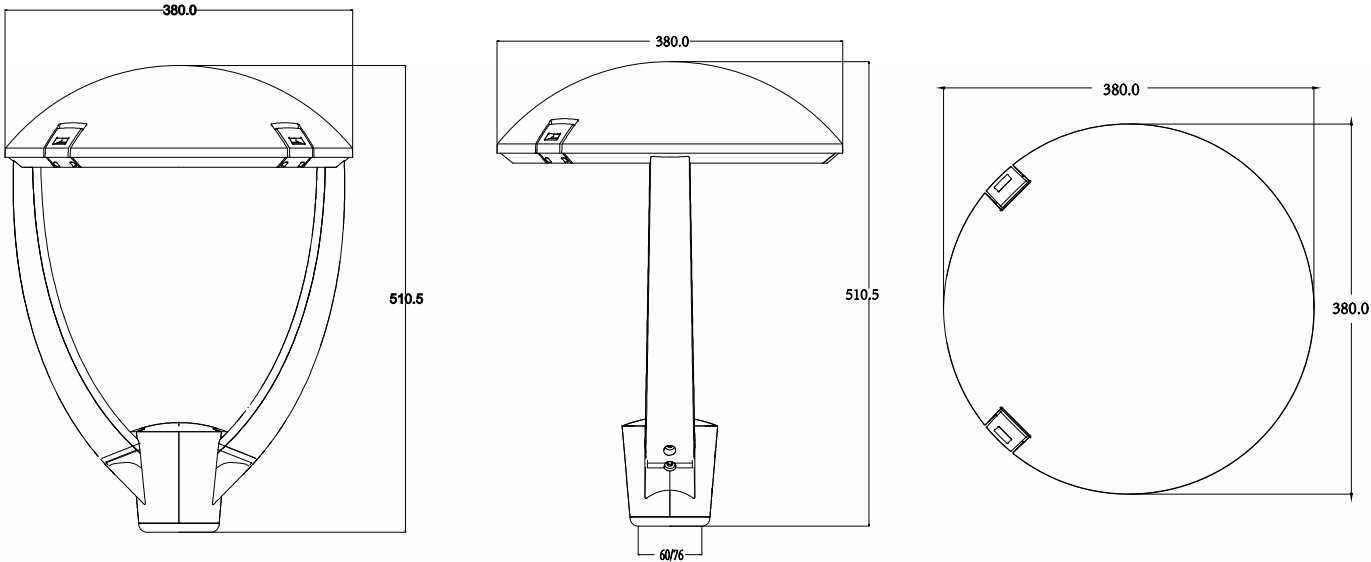

TERA S „B”

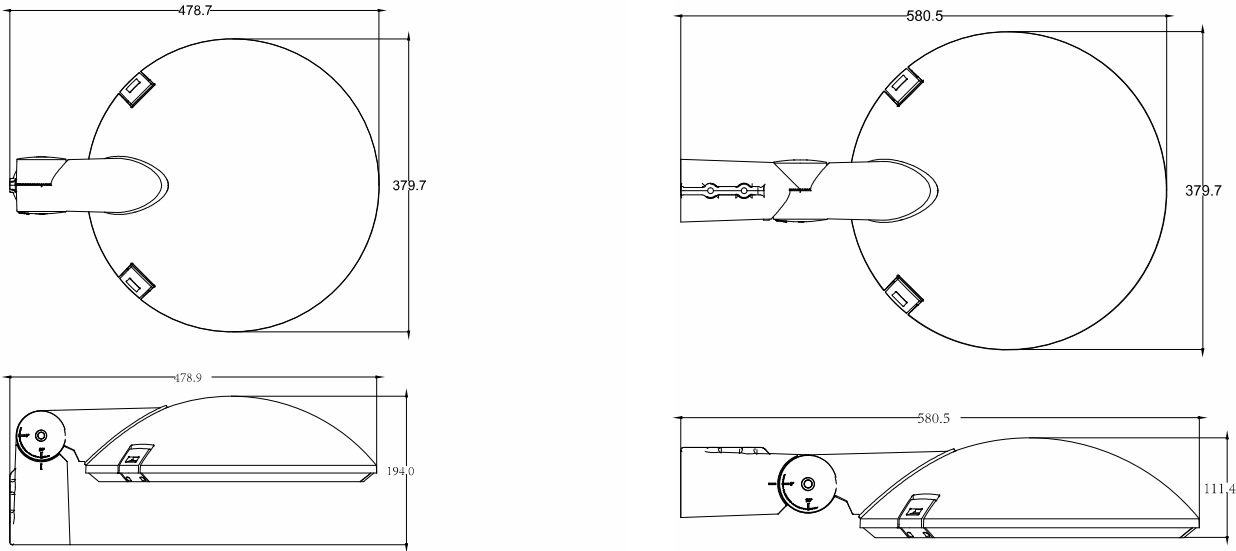

TECHNICAL DATA

	TERA S "P"	TERA S "B"
weight	4,8 kg	4,4 kg with spigot
rated power (input)	up to 60W depends on type and settings	
number of LEDs	24 or 68 LEDs depends on type	
assembly height	3÷8m	
power factor (PF)	$\phi > 0,95/0,90$ - full load at 230 V/half load at 230 V	
LED type	OSRAM OSLONIQ	
colour temperature	4000° K (optional 3000°÷6500°K)	
colour rendering index	typ. CRI >72 up to 82 depends on type	
luminar's efficiency	>124lm/W in all operations modes	
service life	100.000 hours LED and electronics	
ambient temperature	-40°C ÷ +60°C	
rated voltage	170÷264VAC, 50÷60Hz	
IP protection	IP66	
protection class	Class II, Class I	
surge protection	DM 6kV, CM 10kV optional additional SPD 10kV or 20kV	
attachment dimension	on mast or boom, 40 – 60mm (other dimensions on request)	
adjustment angle	within 180°	
warranty	10 years mechanical parts, up to 7 years electronics	
luminair colour finish	RAL9006 different colours on request	

FEATURES

AstroDIM for autonomous dimming (astro, time mode)
MainsDIM function for dimming via reduction of line voltage amplitude
Isolated DALI interface for bidirectional telemanagement system
Isolated 0-10 V interface for unidirectional telemanagement systems
Constant lumen function
Overtemperature protection via external NTC
Standby power consumption: < 0.2 W
Protection through double isolation between mains input and LED output
NEMA C136.41 or Zhaga book 18 socket
Always-on Auxiliary Power
full remote control functionality with command module (ISM band)

